

# COLORADO™ BATTEN 144 TOUR

## User Manual

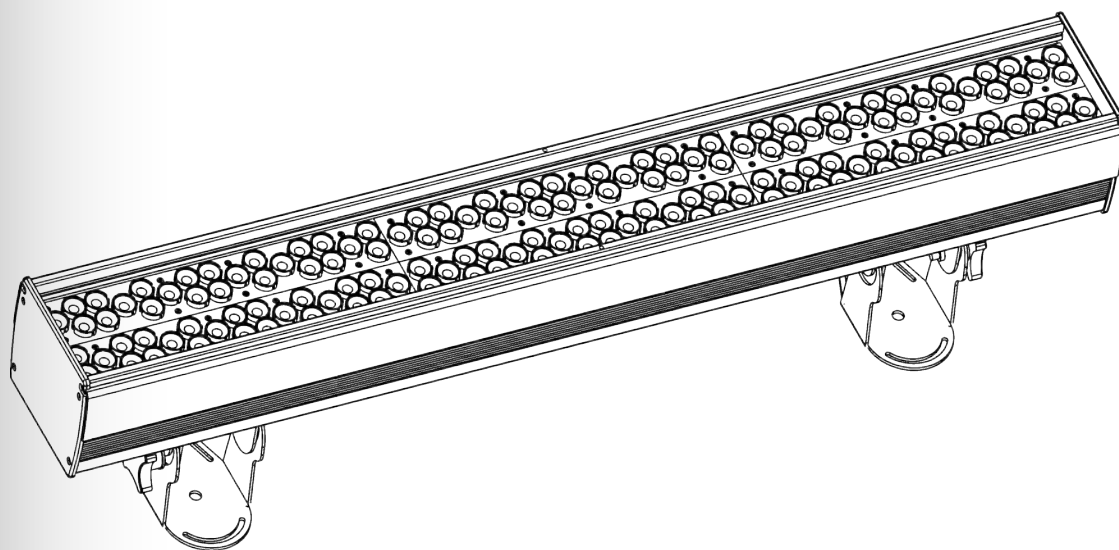

  
**CHAUVET®**

## Edition Notes

The COLORado™ Batten 144 Tour User Manual Rev. 01e covers the description, safety precautions, installation, programming, operation, and maintenance of the COLORado™ Batten 144 Tour. CHAUVET® released this edition of the COLORado™ Batten 144 Tour User Manual in May 2011.

## Trademarks

CHAUVET® is a registered trademark of CHAUVET & Sons Inc. (d/b/a CHAUVET® or Chauvet). The CHAUVET® logo in its entirety including the Chauvet name and the dotted triangle, and all other trademarks on this manual pertaining to services, products, or marketing statements (example: It's Green Thinking™) are owned or licensed by CHAUVET®. Any other product names, logos, brands, company names, and other trademarks featured or referred to within this document are the property of their respective trademark holders.

## Copyright Notice

CHAUVET® owns the content of this user manual in its entirety, including but not limited to pictures, logos, trademarks, and resources.

© Copyright 2011 CHAUVET®. All rights reserved.

Electronically published by CHAUVET® in the United States of America.

## Manual Usage

CHAUVET® authorizes its customers to download and print this manual for professional information purposes only. CHAUVET® expressly prohibits the usage, copy, storage, distribution, modification, or printing of this manual or its content for any other purpose without its written consent.

## Document Printing

For better results, print this document in color, on letter size paper (8.5 x 11 inches), double sided. If using A4 paper (210 x 297 mm), configure your printer to scale the content accordingly.

## Intended Audience

Any person in charge of installing, operating, and/or maintaining this product should read the guide that shipped with it as well as this manual in their entirety before installing, operating, or maintaining this product.

## Disclaimer

CHAUVET® believes that the information contained in this manual is accurate in all respects. However, CHAUVET® assumes no responsibility for any error or omissions in this document. CHAUVET® reserves the right to revise this document and to make changes from time to time in the content hereof without obligation of CHAUVET® to notify any person or company of such revision or changes. This does not constitute in any way a commitment by CHAUVET® to make such changes. CHAUVET® may issue a revision of this manual or a new edition of it to incorporate such changes.

## CHAUVET® Publications Hot Line

If you have any comments about the accuracy of this document or general suggestions regarding how we can improve it, please call us at (800) 762-1084 (US callers) or +1-954-929-1115 (international callers). You can download the latest versions of all CHAUVET® products' manuals from [www.chauvetlighting.com](http://www.chauvetlighting.com).

## Document Revision

The COLORado™ Batten 144 Tour User Manual Rev. 01e supersedes all previous versions of this manual. Please discard any older versions of this manual you may have, whether in printed or electronic format, and replace them with this version.

Author	Editor	Manager	PD Manager
O. Desmonteix	D. Coupepe	M. Graham	F. Sellers

# Table of Contents

- 1. Before You Begin ..... 1**
  - What is Included..... 1
  - Unpacking Instructions..... 1
  - Typographic Conventions ..... 1
  - Icon Meaning..... 1
  - Product at a Glance ..... 1
  - Safety Notes..... 2
  - Expected LED Lifespan ..... 2
- 2. Introduction ..... 3**
  - Product Description..... 3
  - Features ..... 3
    - Additional Features*..... 3
    - Options* ..... 3
  - Product Overview..... 4
- 3. Setup ..... 5**
  - AC Power ..... 5
    - AC Plug* ..... 5
    - Power Linking*..... 5
    - Fuse Replacement* ..... 5
  - DMX Linking..... 6
    - DMX Modes*..... 6
    - Master/Slave Connectivity*..... 6
  - Glare Shield ..... 6
  - Lens Replacement..... 7
  - Mounting ..... 8
    - Orientation*..... 8
    - Rigging* ..... 8
- 4. Operation ..... 9**
  - Control Panel Description ..... 9
  - Control Options ..... 9
  - Programming..... 9
    - DMX Personality*..... 9
    - DMX Control*..... 9
    - Static Color*..... 10
    - Auto Programs*..... 10
    - Edit Customs*..... 10
    - Master/Slave*..... 10
    - Color Settings*..... 11
    - Dimmer Curves*..... 11
    - Control Panel Lock* ..... 11
    - Fan Setting* ..... 11
    - Program Upload* ..... 12
    - Reset*..... 12
    - Color Macro Adjustment* ..... 12
    - RGBW to White Setting* ..... 13
  - TOUR Notes..... 13
    - Master Dimmer*..... 13
    - Red, Green, Blue White, and Amber Color Selection* ..... 13
    - Color Macros* ..... 13
    - Strobe*..... 13
    - Auto/Custom/Fan*..... 13
    - Dimmer Speed*..... 13
  - Menu Map ..... 14

---

DMX Values .....	15
<i>TOUR</i> .....	15
<i>TOUR (Cont.)</i> .....	16
<i>ARC1</i> .....	16
<i>ARC1 + D</i> .....	16
<i>ARC3</i> .....	16
<i>ARC3+D</i> .....	16
<i>ARC3+S</i> .....	17
<i>BLOCK1</i> .....	17
<i>BLOCK2</i> .....	17
<i>HSV</i> .....	17
<b>5. Technical Information .....</b>	<b>18</b>
Fixture Maintenance .....	18
Troubleshooting Guide .....	19
Returns Procedure .....	20
Claims .....	20
Contact Us .....	20
Technical Specifications .....	21

# 1. Before You Begin

## What is Included

- One COLORado™ Batten 144 Tour
- One glare shield
- One power input cord
- One safety cable
- Warranty Card
- Quick Reference Guide

## Unpacking Instructions

Immediately upon receiving this product, carefully unpack it and check the container in which you received it. Make sure that you have received all the parts indicated above and that they are all in good condition. If the material inside the container (this product and any other accessory included with it) appears damaged from shipping, or if the container shows signs of mishandling, notify the shipper immediately. In addition, retain the container and all the packing material for inspection.

See the *Claims* section in the *Technical Information* chapter.

## Typographic Conventions

Convention	Meaning
1~512	A range of values in the text
50/60	A set of mutually exclusive values in the text
<i>Claims</i>	A new term, or a section or chapter in this document
“COLORado™ 1 UM”	The name of another publication or manual
<SET>	A button on the fixture’s control panel
<b>Settings</b>	A fixture function or a menu option
<b>MENU &gt; Settings</b>	A sequence of menu options
1~10	A range of menu values from which to choose in a menu
Yes/No	A set of two mutually exclusive menu options in a menu
ON	A unique value to be entered or selected in a menu

## Icon Meaning

Icon	Meaning
	This icon indicates critical installation, configuration, or operation information. Failure to comply with this information may render the fixture partially or completely inoperative, damage third-party equipment, or cause harm to the user.
	This icon indicates important installation or configuration information. Failure to comply with this information may prevent the fixture from functioning correctly.
	This icon indicates useful, although non-critical information.



The term “DMX” used throughout this document refers to the USITT DMX512-A transmission protocol.

## Product at a Glance

Use on Dimmer	X	Auto Programs	P
Outdoor Use	X	Auto-ranging Power Supply	P
Sound Activated	X	Replaceable Fuse	P
DMX	P	User Serviceable	X
Master/Slave	P	Duty Cycle	X

## Safety Notes

Please read the following notes carefully because they include important safety information about the installation, usage, and maintenance of this product. It is important to read all these notes before starting to work with this product.



**There are no user serviceable parts inside this product. Any reference to servicing it you may find from now on in this User Manual will only apply to properly CHAUVET® certified technicians. Do not open the housing or attempt any repairs unless you are one of them.**



**Please refer to all applicable local codes and regulations for the proper installation of this product.**

### Personal Safety

- Avoid direct eye exposure to the light source while the fixture is on.
- Always disconnect this product from its power source before servicing.
- Always connect this product to a grounded circuit to avoid the risk of electrocution.
- Do not touch this product's housing when operating because it may be very hot.

### Mounting and Rigging

- This product is for indoor use only! To prevent risk of fire or shock, do not expose this product to rain or moisture.
- Make sure there are no flammable materials close to this product while operating.
- When hanging this product, always secure it to a fastening device using a safety chain/cable (included).

### Power and Wiring

- Always make sure that you are connecting this product to the proper voltage, as per the specifications in this manual or on the product's sticker.
- Never connect this product to a dimmer pack or rheostat.
- Never disconnect this product by pulling or tugging on the power cable.

### Operation

- Do not operate this fixture if you see damage on the housing, lenses, or cables. In any of these cases, have the damaged parts replaced by an authorized technician at once.
- Do not cover the ventilation slots when the fixture is operating to avoid internal overheating.
- The maximum ambient temperature (Ta) is 104° F (40° C). Do not operate this product at a higher temperature.
- In case of a serious operating problem, stop using this product immediately!



**In the unlikely event that your product may require service, please contact CHAUVET® Technical Support.**

## Expected LED Lifespan

LEDs gradually decline in brightness over time, mostly because of heat. Packaged in clusters, LEDs exhibit higher operating temperatures than in ideal, single LED conditions. For this reason, using clustered LEDs at their fullest intensity significantly reduces the LEDs' lifespan. Under normal conditions, this lifespan can be of 40,000 to 50,000 hours. If extending this lifespan is vital, lower the operational temperature by improving the fixture's ventilation and reducing the external temperature. In addition, limiting the overall projection intensity may also help to extend the LEDs' lifespan.

## 2. Introduction

### **Product Description**

The COLORado™ Batten 144 Tour is RGBWA linear LED wash light fixture. It consists of a single module that accommodates the internal power supply, the main control, the control panel, the LED drivers, the LED boards and lenses as well as the power and signal connectors. It features two mounting brackets that double as floor mount feet and hanging support brackets. These brackets have tilt adjust knobs to simplify mounting this fixture.

### **Features**

- 3, 4, 5, 6, 7, 9, 12, or 15-channel RGBWA linear LED wash light
- Operating modes:
  - 3-channel: Hue, saturation, value control (HSV)
  - 3-channel: RGB control (ARC1)
  - 4-channel: RGB, dimmer (ARC1+D)
  - 5-channel: RGBWA (ARC3)
  - 6-channel: RGBWA, dimmer (ARC3+D)
  - 7-channel: RGBWA, dimmer, strobe (ARC3+S)
  - 9-channel: RGB control per block (BLOCK1)
  - 12-channel: RGBWA, dimmer, color macro, strobe, auto/custom, auto speed, module select, dimmer speed (TOUR)
  - 15-channel: RGBWA control per block (BLOCK2)
- RGBWA color mixing with or without DMX controller
- Built-in automated programs via DMX
- User configurable programs (custom)
- Recall custom or auto programs via master/slave or DMX

### **Additional Features**

- Five distinct dimming curves
- Additional power output: max. 3 units @ 120 V
- Neutrik® powerCON® connectors
- 3- and 5-pin DMX input and output connectors
- LCD display with password protection

### **Options**

- 20-pc, 30° Lens Kit (01110081)
- 24-pc, 15° Lens Kit (01110082)

### Product Overview

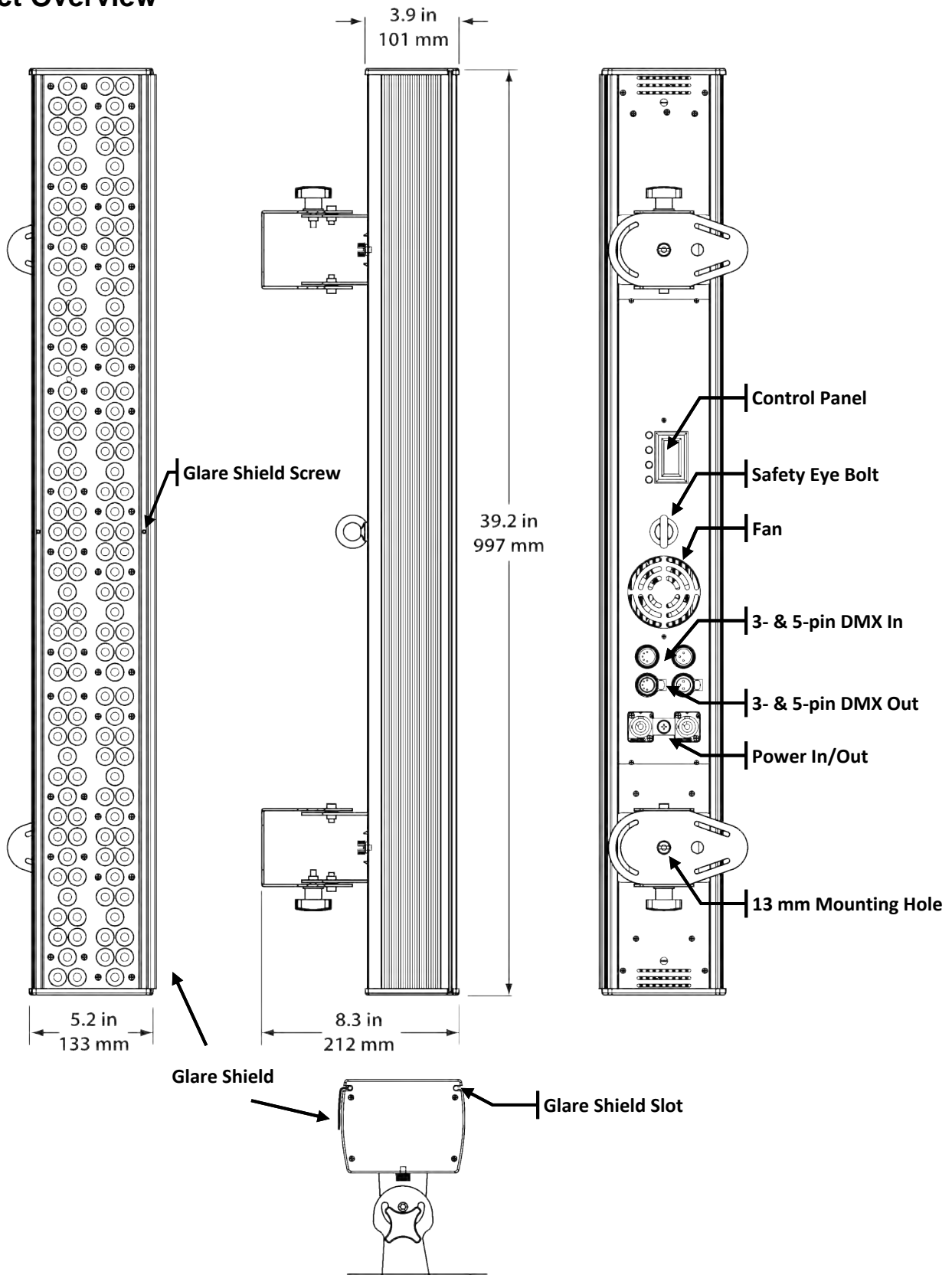

### 3. Setup

#### AC Power

The COLORado™ Batten 144 Tour has an auto-ranging power supply that can work with an input voltage range of 100~240 VAC, 50/60 Hz.

Make sure that you are connecting this product to the proper voltage, as per the specifications in this guide, the product's user manual, or on the product's sticker.



**Always connect this product to a protected circuit with an appropriate electrical ground to avoid the risk of electrocution or fire.**

To determine the power requirements for the COLORado™ Batten 144 Tour see the label affixed to the side of the fixture. Alternatively, you may refer to the *Technical Specifications* chart in the *Technical Information* chapter of this manual.

The listed current rating indicates the maximum current draw during normal operation. For more information, you may download the "Sizing the Circuit Breakers" document from the CHAUVET® Web site.



**Never connect this product to a rheostat (variable resistor) or dimmer circuit, even if the rheostat or dimmer channel serves only as a 0 to 100% switch.**

#### AC Plug

The COLORado™ Batten 144 Tour comes with a power input cord terminated with a Neutrik® powerCON® A/IEC connector on one end an Edison plug on the other end (US market). If the power input cord that came with your product has no plug or you need to change the Edison plug, use the table below to wire the new plug.

Connection	Wire (US)	Wire (Europe)	Screw Color
AC Live	Black	Brown	Yellow or Brass
AC Neutral	White	Blue	Silver
AC Ground	Green/Yellow	Green/Yellow	Green

#### Power Linking

You can link up to three (3) COLORado™ Batten 144 Tour units to this product at 120 VAC. Make sure to never exceed this number.



**Make sure to disconnect the fixture's power cord before replacing a blown fuse, and always replace it with a fuse of the same type and rating.**

#### Fuse Replacement

- 1) Disconnect the fixture from the power outlet.
- 2) With a Phillips #2 head screwdriver, unscrew the fuse holder cap from its housing.
- 3) Remove the blown fuse and replace it with a good fuse of the same type and rating (F 3.15 A @ 250 V).
- 4) Screw the fuse holder cap back in its place and reconnect power.



## DMX Linking

You may link the COLORado™ Batten 144 Tour to a DMX controller using a standard DMX serial connection. If using other DMX compatible fixtures with this product, it is possible to control them individually with a single DMX controller.

If you are not familiar with the DMX standard, or if you need information about the DMX cables needed to link this product to a DMX controller, you may download the “DMX Primer” document from the CHAUVET® Web site.

## DMX Modes

The COLORado™ Batten 144 Tour uses the standard DMX data connection for its **TOUR**, **BLOCK1**, **BLOCK2**, **ARC1**, **ARC1+D**, **ARC3**, **ARC3+D**, **ARC3+S**, and **HSV** DMX personalities. You will find information about these DMX mode in the *Operation* chapter (configuration details), and the *DMX Values* section (individual channel values).

## Master/Slave Connectivity

The Master/Slave mode allows a COLORado™ Batten 144 Tour fixture to control one or more fixtures of the same model without a DMX controller. The controlling fixture becomes the “master fixture” when running an Auto or Custom program, or by being in STATIC mode. You must configure the controlled (slave) fixtures to operate in “SLAVE” mode from their respective control panels. During the Master/Slave operation, the slave fixtures will operate in unison with the master fixture.

The master links to the slave fixtures using the standard DMX serial connection. If you are not familiar with the Master/Slave connectivity, you may download the “DMX Primer” document from the CHAUVET® Web site.



**DO NOT connect a DMX controller to the fixtures operating in Master/Slave mode. Otherwise, the signals from the DMX controller may interfere with the signals from the master fixture.**



The *Operation* chapter of this manual provides detailed instructions on how to configure the Master and Slave units.

## Glare Shield

The COLORado™ Batten 144 Tour comes with a glare shield already mounted on the side of the unit. Please refer to the *Product Overview* diagram for reference.

To extend the glare shield, do the following:

- 1) Loosen the glare shield screw on the front of the fixture.
- 2) Slide the glare shield on either direction until it is free.
- 3) Turn over and reinsert the glare shield into either slot so it projects itself over the LEDs lens cover, as shown below.
- 4) Adjust the angle of the glare shield and tighten the glare shield screw.

### Extending the Glare Shield

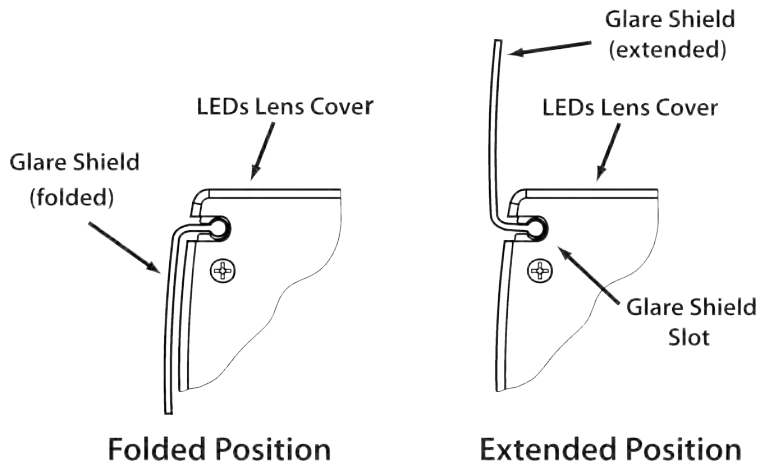

## Lens Replacement

The COLORado™ Batten 144 Tour comes with 15° and 30° lenses already installed. However, it is possible to change this configuration by using the optional 15° or 30° LED lenses. In this case, you may order as many 15° or 30° lens kits, as necessary to suit your needs. Follow the instructions below to to change or replace the LED lenses.



- **Disconnect the fixture from the AC power before opening it.**
- **This procedure gives you direct access to the LEDs, which are very fragile. Use maximum care when handling the lenses over the LED assembly.**



- **The numbers in parenthesis in the procedure below correspond to the parts indicated in the *Lens Replacement Diagram*.**
- **The lenses in the 15° lens kit come already mounted on a lens holder, whereas the lenses of the 30° lens kit come in a bag.**

### Procedure

- 1) Remove the four screws that hold either one of the side covers (1).
- 2) Remove the plastic side cover and the internal metallic plate (2).
- 3) Slide the clear cover (3) along the rails (4) to expose the lens holders (5).
- 4) Remove the eight screws that hold each of the six lens holders.
- 5) Remove the lens holders from the fixture.
- 6) Make sure not to touch the LED board (6) in the process.
- 7) If installing 15° lenses, just install the new lens holder with the 15° lenses.
- 8) If installing 30° lenses:
  - a) Remove the existing lenses (7) from the lens holder by pushing them from the back.
  - b) Install the new lenses on the lens holder, making sure that you have inserted them fully into the lens sockets.
- 9) Reverse steps “1” to “5” to complete the lens replacement procedure.

Lens Replacement Diagram

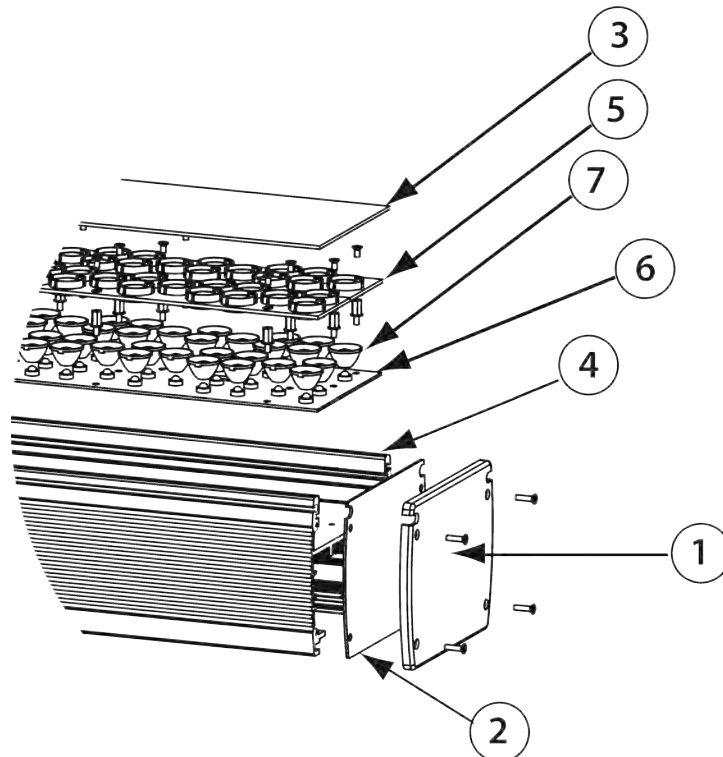

**Mounting**

Before mounting this product, read and follow the safety recommendations indicated in the *Safety Notes* section (page 2 of this manual).

**Orientation**

Always mount this product in any safe position while making sure that there is adequate room around it for ventilation, configuration, and maintenance.

**Rigging**

CHAUVET® recommends following the general guidelines below when mounting this product.

- When selecting an installation location, consider ease of access to the fixture for operation, programming adjustments, and routine maintenance.
- Make sure to mount this product away from any flammable material as indicated in the *Safety Notes* section.
- Never mount the product in places where rain, high humidity, extreme temperature changes, or restricted ventilation may affect it.
- If hanging this product, make sure that the location where you are mounting it can support its weight. Please see the *Technical Specifications* section of this manual for the weight requirement of this fixture.

**Procedure**

The COLORado™ Batten 144 Tour comes with two adjustable feet that double as hanging brackets to which you can attach “C” or “O” clamps. These feet also serve as floor or wall mount supports. You must supply your own “C” or “O” clamps and make sure that they are capable of supporting the weight of this fixture. You will have to use two mounting points per fixture.

**Product Mounting Diagram**

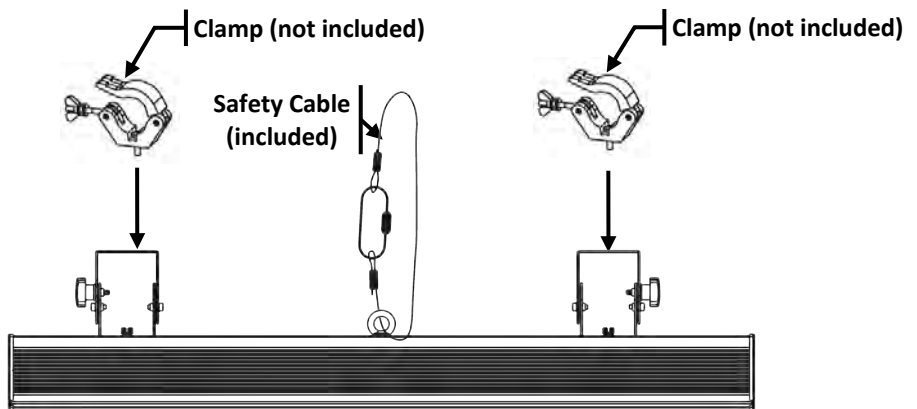

**Overhead Mounting**

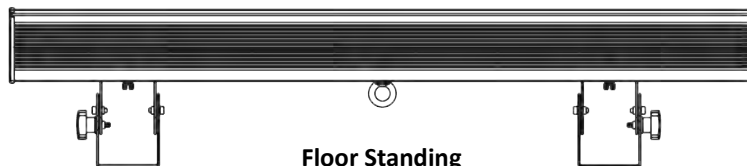

**Floor Standing**

## 4. Operation

### Control Panel Description

Button	Function
<MENU>	Exits from the current menu or function
<ENTER>	Enables the currently displayed menu or sets the currently selected value in to the current function
<UP>	Navigates upwards through the menu list and increases the numeric value when in a function
<DOWN>	Navigates downwards through the menu list and decreases the numeric value when in a function

### Control Options

You can set the COLORado™ Batten 144 Tour start address in the 001–512 DMX range. This allows for the control of up to 34 fixtures in the 15-channel **BLOCK2** personality.

### Programming

Refer to the *Menu Map* on page 14 to learn how the menu options relate to each other. The menu map has a Menu Level and a variable number of programming levels for each option. To go to an option in the Menu Level, press <MENU> repeatedly until the option shows on the display. Press <ENTER> to select it. This will take you to the first programming level for that option.

To select an option or value within the current programming level press <UP> or <DOWN> until it shows on the display. Press <ENTER> to accept it. In this case, if there is another programming level, you will see its first option. Otherwise, you will see the selected value. To exit to the previous menu level, press <MENU>.

### DMX Personality

This setting allows the user to choose a particular DMX personality.

- 1) Go to **PERS**.
- 2) Select the desired personality (**TOUR**, **ARC1**, **AR1+D**, **ARC3**, **AR3+D**, **AR3+S**, **HSV**, **BLOCK1**, or **BLOCK2**).



- See the **DMX Values** section for the highest starting address you can select for each personality.
- Make sure that the starting addresses on the various fixtures do not overlap due to the new personality setting. See the **DMX Values** section.

### DMX Control

In this mode, each unit will respond to a unique starting address from the DMX controller. All units with the same starting address will respond in unison.

- 1) Select a DMX personality as shown in DMX Personality.
- 2) Set the running mode:
  - a) Go to **RUN**.
  - b) Select **DMX**.
- 3) Set the starting address:
  - a) Go to **ADDRESS**.
  - b) Select the starting address (**001–512**).



The highest recommended starting address for each DMX mode are as follows:

DMX Mode	DMX Address	DMX Mode	DMX Address	DMX Mode	DMX Address
<b>TOUR</b>	501	<b>ARC3</b>	508	<b>HSV</b>	510
<b>ARC1</b>	510	<b>ARC3+D</b>	507	<b>BLOCK1</b>	504
<b>ARC1+D</b>	509	<b>ARC3+S</b>	506	<b>BLOCK2</b>	498

Continues on the next page

Continued from previous page

**Static Color**

The Static Color mode allows for permanent RGBWA color mixing without a DMX controller.

- 1) Go to **STATIC**.
- 2) Select the desired color (**RED, GREN, BLUE, WHIT, or AMBE**).
- 3) Select the desired color value (**0~255**).
- 4) Repeat for the other colors.
- 5) Select **STRB**.
- 6) Select the desired frequency (**0~20**).

**Auto Programs**

Auto programs allow for dynamic RGBWA color mixing without a DMX controller.

- 1) Go to **AUTO**.
- 2) Select the desired auto (**AUTO01~10**) or custom program (**CUSTOM01~10**).
- 3) When selecting an auto program, you can also select the auto playing speed (**SP000~255**).



**You cannot edit any of the auto programs (AUTO01~10). However, you can edit the custom programs (CUSTOM01~10). See *Edit Customs* for details.**

**Edit Customs**

This setting allows the programming of up to 30 scenes for each of the 10 customizable programs, including colors and effects.

- 1) Go to **EDIT**.
- 2) Select the desired auto program (**CUSTOM01~10**).
- 3) Select the desired scene (**SCENE01~30**).
- 4) Select the desired color or effect (**RED, GREN, BLUE, WHIT, AMBR, STRB, TIME, or FADE**).
- 5) Select the color or effect value (**000~255** for colors and timers, or **00~20** for strobe).
- 6) Repeat for the other colors or effects.
- 7) Return to the **SCENE** level (step “3”).
- 8) Repeat the settings of colors and effects for the other scenes.

**Master/Slave**

The Master/Slave mode allows a group of COLORado™ Batten 144 Tour fixtures (the slave units) to simultaneously duplicate the output of another COLORado™ Batten 144 Tour (the master unit), whether static mode settings or auto/custom programs, without a DMX controller.

- 1) Set the master unit:
  - a) Set the running mode to **DMX** as explained in “*DMX Control*”.
  - b) Select an auto or custom program as explained in “*Auto Programs*”, or a static mix of colors.
- 2) Set each of the slave units:
  - a) Go to **RUN**.
  - b) Select **SLAVE**.



- **The master unit is the fixture that is set to run a program, whether Auto or Custom, or to operate in Static mode.**
- **Do not connect a DMX controller to the master or slave fixtures.**
- **The master unit should be the first in the DMX string.**

Continues on the next page

Continued from previous page

### Color Settings

The **COLOR** setting determines how the COLORado™ Batten 144 Tour generates the white color based on various RGB settings.

- 1) Go to **SETTINGS**.
- 2) Select **COLOR**.
- 3) Select **OFF**, **RGBTOW**, or **UC**.

**OFF:** When the RGB faders are all set to “255”, the output is maximum, although the resulting white color may not be balanced.



**RGBTOW:** When the RGB faders are all set to “255”, the resulting output is defined by the configured White color (see *RGB to White Settings*).

**UC:** When the RGB faders are all set to “255”, the output matches that of less efficient fixtures (Universal Color).

### Dimmer Curves

This setting determines how fast the output of the COLORado™ Batten 144 Tour changes when the operator modifies the values of the Red, Green, Blue, White, Amber, and Dimmer faders.

- 1) Go to **SETTINGS**.
- 2) Select **DIMMER**.
- 3) Select a dimmer curve (**OFF**, **DIM1**, **DIM2**, **DIM3**, or **DIM4**).

**OFF:** The output is proportional (linear) to the Dimmer and RGBWA channel values.



**DIM1-4:** The output follows the Dimmer and RGBWA channel values based on the corresponding dimmer curve, being **DIM1** the fastest and **DIM4** the slowest.

### Control Panel Lock

This setting allows the user to activate or disable the control panel lock, which keeps non-authorized personnel from changing the fixture’s settings.

- 1) Go to **KEYLOCK**.
- 2) Select **ON** or **OFF**.



**When the control panel lock is active, the fixture will prompt the user to enter the password after 30 seconds of control panel inactivity or after turning on the fixture.**

After being prompted to enter the password:

Press **<UP>**, **<DOWN>**, **<UP>**, **<DOWN>**, and **<ENTER>**.

### Fan Setting

- 1) Press **<MENU>** repeatedly until **FANS** shows, and press **<ENTER>** to accept.
- 2) Use **<UP>** or **<DOWN>** to select a setting (**OFF**, **LOW**, **NORMAL**, **HIGH**, or **AUTO**).
- 3) Press **<MENU>** to exit once done.



- **When in AUTO, the fan speed automatically changes so the fixture’s temperature does not exceed the maximum allowed value.**
- **When in the other settings, the fan speed follows the predefined values.**
- **The internal controller will override any manual setting if the internal temperature rises above a certain level.**

Continues on the next page

Continued from previous page

### Program Upload

This option allows the user to copy the custom programs of one COLORado™ Batten 144 Tour fixture onto other COLORado™ Batten 144 Tour fixtures by using the Master/Slave method.

- 1) Configure and connect the fixtures in a Master/Slave arrangement, where the master unit has the custom programs you want to transfer onto the slave units.
- 2) At the master unit, go to **SETTINGS**.
- 3) Select **UPLOAD**.
- 4) When **PASSWORD** shows, press **<ENTER>**.
- 5) At the blinking cursor, enter the master access password as shown in *Control Panel Lock*.
- 6) **SEND** will show, indicating that the upload has started.
- 7) Wait for the upload process to finish (the display will show **MAIN**) before continuing or turning the fixtures off.

During and after the upload, the master and slave units will visually indicate the status of the process, as follows:



- **Yellow** means that the upload is running.
- **Red** means that the upload failed due to an error.
- **Green** means that the upload completed successfully.



**DO NOT** upload the program from a COLORado™ Batten 144 Tour onto a different fixture. Otherwise, you could render the other fixture inoperative.

### Reset

This setting allows the user to reset the COLORado™ Batten 144 Tour fixture to its default values, including the custom programs.

- 1) Go to **SETTINGS**.
- 2) Select **RESET**.
- 3) When **PASSWORD** shows, press **<ENTER>**.
- 5) Enter the master access password as shown in *Control Panel Lock*.
- 4) Wait for the reset process to finish.

### Default Values

Parameter	Default Value	Parameter	Default Value
<b>STAT</b>	R/G/B/W/A/S.000	<b>COLO</b>	UC
<b>AUTO</b>	AUTO01	<b>EDIT</b>	PR.01/SC.01
<b>ADDR</b>	DMX.001	<b>CAL1</b>	WH.01
<b>RUN</b>	DMX	<b>RGB.W</b>	R/G/B.255
<b>PERS</b>	TOUR	<b>FANS</b>	LOW
<b>DIM</b>	DIM4	<b>KEYLOCK</b>	OFF

### Color Macro Adjustment

This setting allows the user to select and edit the temperature of the white colors used in channel 7 (Macros) when in the **TOUR** personality.

- 1) Go to **CALIB1**.
- 2) Select a white color (**WHITE1~11**).
- 3) Select a color (**RED, GREN, BLUE, WHIT, or AMBE**).
- 4) Select a color value (**0~255**).
- 5) Repeat for the other colors.

Continues on the next page

Continued from previous page

### **RGBW to White Setting**

This setting allows the user to define the maximum RGB values when RGB to White (**RGBTOW**) is active.

- 1) Go to **CALIB2**.
- 2) Press **<ENTER>** when you see **RGBTOW** on the display.
- 3) Select a color (**RED**, **GREEN**, or **BLUE**).
- 4) Select a color value (**0~255**).
- 5) Repeat for the other colors.



When selecting **RGB TO W**, you will only be able to define the values of **RED**, **GREEN**, and **BLUE**.



The values of **RED**, **GREEN**, and **BLUE** configured from **CALIB2 > RGBTOW** will define the color temperature shown when the RGB faders are set to “255” if **SETTINGS > COLOR > RGBTOW** is active.

### **TOUR Notes**

These notes intent to clarify the way the **TOUR** DMX personality works.

#### **Master Dimmer**

- Channel 1 controls the intensity of the currently projected color.
- When the slider is at the highest position (**255**) the intensity of the output is at its maximum.

#### **Red, Green, Blue White, and Amber Color Selection**

- Channels 2 through 6 control the intensity ratio of each of the Red, Green, Blue, White, and Amber LEDs.
- When the fader is at the highest position (**255**), the intensity of each color is at its maximum if **SETTINGS > COLOR** is **OFF**.
- You can combine channels 2 through 6 to create over one trillion colors.

#### **Color Macros**

- Channel 7 selects the required Color Macro.
- Channel 7 has priority over channels 2 through 6.
- Channel 1 controls the intensity of the Color Macro.

#### **Strobe**

- Channel 8 controls the strobe frequency (not the intensity) of channels 2 through 7.
- Channel 8 can strobe channels 2 through 6 when not running macros, allowing the individual faders (R, G, B, W, and A) as well as channel 1 (D) to control the output intensity.
- Channel 8 can strobe channel 7 when running macros, allowing channel 7 to select the macro and channel 1 to control the output intensity.

#### **Auto/Custom/Fan**

- Channel 9 selects the preset auto programs **AUTO01~10** or the custom programs **CUSTOM01~10** as well as the fan speed.
- When activating the custom Auto programs **CUSTOM01~10**, it is possible to control the Step Time and Fade Time using channels 2 and 3 respectively.
- Channel 9 has priority over channels 2 through 8.
- Channel 10 controls the speed at which each auto programs plays.

#### **Dimmer Speed**

- Channel 10 selects the dimmer mode and speed. When **DIMMER** is set to **OFF**, the changes in the RGBWA and Master Dimmer faders are linear. Otherwise, **DIM1** is the fastest dimmer curve, while **DIM4** is the slowest.

## Menu Map

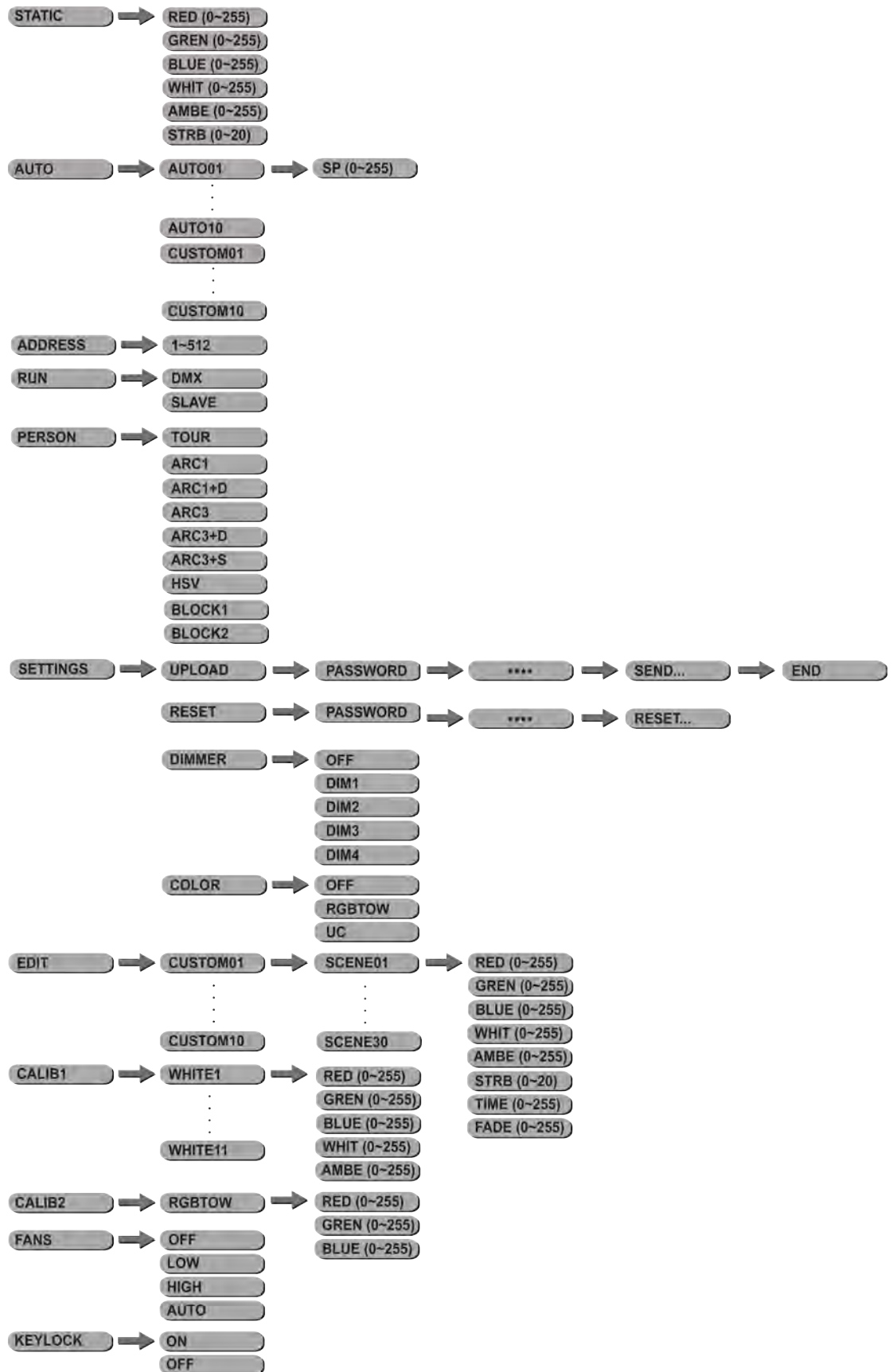

DMX Values

<i>TOUR</i>	Channel	Function	Value	Percent/Setting
	1	Master Dimmer	000 ó 255	0~100%
	2	Red	000 ó 255	0~100%
		Step Time		(Only if running Custom programs)
	3	Green	000 ó 255	0~100%
		Fade Time		(Only if running Custom programs)
	4	Blue	000 ó 255	0~100%
	5	White	000 ó 255	0~100%
	6	Amber	000 ó 255	0~100%
	7	Color Macro + White Balance	000 ó 010	No function
			011 ó 030	R: 100% G: Up B: 0%
			031 ó 050	R: Down G: 100% B: 0%
			051 ó 070	R: 0% G: 100% B: Up
			071 ó 090	R: 0% G: Down B: 100%
			091 ó 110	R: Up G: 0% B: 100%
			111 ó 130	R: 100% G: 0% B: Down
			131 ó 150	R: 100% G: Up B: Up
			151 ó 170	R: Down G: Down B: 100%
			171 ó 200	R / G / B / W / A: 100%
			201 ó 205	White 1: 3200 K
			206 ó 210	White 2: 3400 K
			211 ó 215	White 3: 4200 K
			216 ó 220	White 4: 4900 K
			221 ó 225	White 5: 5600 K
			226 ó 230	White 6: 5900 K
			231 ó 235	White 7: 6500 K
	236 ó 240	White 8: 7200 K		
	241 ó 245	White 9: 8000 K		
	246 ó 250	White 10: 8500 K		
	251 ó 255	White 11: 10,000 K		
	8	Strobe	000 ó 009	No function
			010 ó 255	1~20 Hz
	9	Auto + Custom Programs + Fan Control	000 ó 010	No function
			011 ó 020	Fans Off (Hold for 3 s)
			021 ó 025	Fans Low (Hold for 3 s)
			026 ó 030	Fans High (Hold for 3 s)
			031 ó 040	Fans Auto (Hold for 3 s)
			041 ó 050	Auto 1
			051 ó 060	Auto 2
			061 ó 070	Auto 3
			071 ó 080	Auto 4
			081 ó 090	Auto 5
			091 ó 100	Auto 6
			101 ó 110	Auto 7
			111 ó 120	Auto 8
			121 ó 130	Auto 9
			131 ó 140	Auto 10
			141 ó 150	Custom 1
			151 ó 160	Custom 2
	161 ó 170	Custom 3		
	171 ó 180	Custom 4		
	181 ó 190	Custom 5		
	191 ó 200	Custom 6		
	201 ó 210	Custom 7		
	211 ó 220	Custom 8		
	221 ó 230	Custom 9		
	231 ó 255	Custom 10		

Continues on the next page

Continued from previous page

**TOUR (Cont.)**

Channel	Function	Value	Percent/Setting
10	Auto Speed	000 ó 255	0~100%
11	Dimmer Speed	000 ó 009	Dimmer speed as per Control Panel
		010 ó 029	Linear dimmer
		030 ó 069	Non-linear dimmer 1 (fastest)
		070 ó 129	Non-linear dimmer 2
		130 ó 189	Non-linear dimmer 3
12	Block Selection	190 ó 255	Non-linear dimmer 4 (slowest)
		000 ó 004	Blocks 1, 2, & 3
		005 ó 034	Block 1
		035 ó 064	Block 2
		065 ó 094	Block 3
		095 ó 124	Blocks 1 & 2
		125 ó 154	Blocks 2 & 3
155 ó 184	Blocks 1 & 3		
185 ó 214	Blocks 1, 2, & 3		
215 ó 255	No Function		

**ARC1**

Channel	Function	Value	Percent/Setting
1	Red	000 ó 255	0~100%
2	Green	000 ó 255	0~100%
3	Blue	000 ó 255	0~100%

**ARC1 + D**

Channel	Function	Value	Percent/Setting
1	Master Dimmer	000 ó 255	0~100%
2	Red	000 ó 255	0~100%
3	Green	000 ó 255	0~100%
4	Blue	000 ó 255	0~100%

**ARC3**

Channel	Function	Value	Percent/Setting
1	Red	000 ó 255	0~100%
2	Green	000 ó 255	0~100%
3	Blue	000 ó 255	0~100%
4	White	000 ó 255	0~100%
5	Amber	000 ó 255	0~100%

**ARC3+D**

Channel	Function	Value	Percent/Setting
1	Master Dimmer	000 ó 255	0~100%
2	Red	000 ó 255	0~100%
3	Green	000 ó 255	0~100%
4	Blue	000 ó 255	0~100%
5	White	000 ó 255	0~100%
6	Amber	000 ó 255	0~100%

**ARC3+S**

Channel	Function	Value	Percent/Setting
1	Master Dimmer	000 ó 255	0~100%
2	Red	000 ó 255	0~100%
3	Green	000 ó 255	0~100%
4	Blue	000 ó 255	0~100%
5	White	000 ó 255	0~100%
6	Amber	000 ó 255	0~100%
7	Strobe	000 ó 009 010 ó 255	No Function 0~20 Hz

**BLOCK1**

Channel	Function	Value	Percent/Setting
1	Block 1 Red	000 ó 255	0~100%
2	Block 1 Green	000 ó 255	0~100%
3	Block 1 Blue	000 ó 255	0~100%
4	Block 2 Red	000 ó 255	0~100%
5	Block 2 Green	000 ó 255	0~100%
6	Block 2 Blue	000 ó 255	0~100%
7	Block 3 Red	000 ó 255	0~100%
8	Block 3 Green	000 ó 255	0~100%
9	Block 3 Blue	000 ó 255	0~100%

**BLOCK2**

Channel	Function	Value	Percent/Setting
1	Block 1 Red	000 ó 255	0~100%
2	Block 1 Green	000 ó 255	0~100%
3	Block 1 Blue	000 ó 255	0~100%
4	Block 1 White	000 ó 255	0~100%
5	Block 1 Amber	000 ó 255	0~100%
6	Block 2 Red	000 ó 255	0~100%
7	Block 2 Green	000 ó 255	0~100%
8	Block 2 Blue	000 ó 255	0~100%
9	Block 2 White	000 ó 255	0~100%
10	Block 2 Amber	000 ó 255	0~100%
11	Block 3 Red	000 ó 255	0~100%
12	Block 3 Green	000 ó 255	0~100%
13	Block 3 Blue	000 ó 255	0~100%
14	Block 3 White	000 ó 255	0~100%
15	Block 3 Amber	000 ó 255	0~100%

**HSV**

Channel	Function	Value	Percent/Setting
1	Hue	000 ó 255	0~100%
2	Saturation	000 ó 255	0~100%
3	Value	000 ó 255	0~100%

## 5. Technical Information

### Fixture Maintenance

To maintain optimum performance and minimize wear, the user should clean this product frequently. Usage and environment are contributing factors in determining the cleaning frequency.

As a rule, the user should clean this product at least twice a month. Dust build up reduces light output performance and can cause overheating. This can lead to reduced light source life and increased mechanical wear.

To clean a fixture, follow the recommendations below:

- Unplug the fixture from power.
- Wait until the fixture is cold.
- Use a vacuum (or dry compressed air) and a soft brush to remove dust collected on the external vents and accessible internal components.
- Clean the LED lens cover with a mild solution of non-ammonia glass cleaner or isopropyl alcohol.
- Apply the solution directly to a soft, lint-free cotton cloth or a lens cleaning tissue.
- Drag any dirt or grime to the outside of the LED lens cover.
- Gently polish the LED lens cover until it is free of haze and lint.



**Always dry the LED lens cover carefully after cleaning it.**



**Refrain from spinning this product's fan using compressed air.**

## Troubleshooting Guide

Symptom	Cause(s)	Action(s)
General low intensity	Incorrect COLOR setting Incorrect Macro or RGB to White settings Dirty LED lens cover Misaligned LED lenses	Verify COLOR setting on Control Panel Verify CALIB1 and CALIB2 on Control Panel Clean LED lens cover Realign the LED lenses
Single LED does not illuminate	Faulty LED Faulty LED board Faulty LED Driver board	Send unit for repair
A group of LEDs does not illuminate	Incorrect color control Faulty LED board Faulty LED Driver board Faulty wiring	Check color fader (DMX controller) or color settings (control panel) Send unit for repair Send unit for repair Send unit for repair
None of the LEDs illuminate	Faulty LED board Faulty LED Driver board Faulty Main board	Send unit for repair
Circuit breaker/fuse keeps tripping/blowing	Excessive circuit load Short circuit along the power wires	Reduce total load placed on the electrical circuit Check electrical wiring
Fixture does not power up	No power Loose or damaged power cord Blown fuse Faulty internal power supply	Check for voltage on outlet Check power cord Replace fuse (F 3.15 A @ 250 V) Send unit for repair
Fixture does not respond to DMX or responds erratically	Wrong DMX addressing Damaged DMX cables Wrong polarity on the controller Loose DMX cables Non DMX cables Bouncing signals Long cable / low level signal Too many fixtures Interference from AC wires Faulty DMX interface Faulty Main board	Check unit addressing Check DMX cables Check polarity switch settings on the controller Check cable connections Use only DMX compatible cables Install terminator Install an optically coupled DMX splitter before a long section of cable or right after the fixture with the strong signal Install an optically coupled DMX splitter after unit #32 Keep DMX cables separated from power cables or fluorescent/black lights Send unit for repair Send unit for repair



**If you still experience technical problems after trying the above solutions or you need to send the unit for repair, contact CHAUVET® Technical Support.**

## Returns Procedure

The user must send the merchandise prepaid, in the original box, and with its original packing and accessories. CHAUVET® will not issue call tags.

Call CHAUVET® and request a Return Merchandise Authorization (RMA) number before shipping the fixture. Be prepared to provide the model number, serial number, and a brief description of the cause for the return.

The user must clearly label the package with a Return Merchandise Authorization (RMA) number. CHAUVET® will refuse any product returned without an RMA number.



**DO NOT write the RMA number directly on the box. Instead, write it on a properly affixed label.**

Once you have received the RMA number please include the following information on a piece of paper inside the box:

- Your name
- Your address
- Your phone number
- The RMA number
- A brief description of the problem

Be sure to pack the fixture properly. Any shipping damage resulting from inadequate packaging will be the customer's responsibility. As a suggestion, proper UPS packing or double-boxing is always a safe method to use.



**CHAUVET® reserves the right to use its own discretion to repair or replace returned product(s).**

## Claims

The carrier is responsible for any damage incurred during shipping to this product or any part that shipped with it. Therefore, if the received merchandise appears to have damages caused during shipping, the customer must submit the damage report and any related claims with the carrier, not CHAUVET®. The customer must submit the report upon reception of the damaged merchandise. Failure to do so in a timely manner may invalidate the customer's claim with the carrier.

For other issues such as missing components or parts, damage not related to shipping, or concealed damage, the customer must make claims to CHAUVET® within seven (7) days of receiving the merchandise.

## Contact Us

### World Headquarters

CHAUVET®

#### General Information

Address: 5200 NW 108th Avenue  
Sunrise, FL 33351  
Voice: (954) 929-1115  
Fax: (954) 929-5560  
Toll free: (800) 762-1084

#### Technical Support

Voice: (954) 929-1115 (Press 4)  
Fax: (954) 756-8015

#### World Wide Web

[www.chauvetlighting.com](http://www.chauvetlighting.com)

### United Kingdom & Ireland

CHAUVET® Europe Ltd.

#### General Information

Address: Unit 1C  
Brookhill Road Industrial Estate  
Pinxton, Nottingham, UK  
NG16 6NT

Voice: +44 (0)1773 511115  
Fax: +44 (0)1773 511110

Email: [uktech@chauvetlighting.com](mailto:uktech@chauvetlighting.com)

#### World Wide Web

[www.chauvetlighting.co.uk](http://www.chauvetlighting.co.uk)

## Technical Specifications

### *Dimensions and Weight*

Length	Width	Height	Weight
39.3 in (998 mm)	5.2 in (132 mm)	8.2 in (209 mm)	19.60 lbs (8.89 kg)

**Note:** Dimensions in inches rounded to the nearest decimal digit.

### *Electrical*

Power Supply Type	Range	Voltage Selection
Switching (internal)	100~240 V, 50/60 Hz	Auto-ranging

Parameter	120 V, 60 Hz	230 V, 50 Hz
Consumption	181 W (1.52 A)	169 W (0.79 A)
Inrush current	1.9 A	1.0 A

Power I/O	Input	Output
Connectors	Neutrik® powerCON® A	Neutrik® powerCON® B
Cord plug	Edison	N/A

### *Light Source*

Type	Power	Lifespan
LED (144)	1 W	50,000 hours

Color	Quantity	Current
Red	36	350 mA
Green	36	350 mA
Blue	36	350 mA
White	18	350 mA
Amber	18	350 mA

### *Photo Optic*

Parameter	Standard 15° + 30° Optics
Illuminance @ 5 m	2,000 lx
Beam angle	15.5°
Field angle	34.6°

### *Thermal*

Max. External Temperature	Cooling System
104° F (40° C)	Fan

### *DMX*

I/O Connectors	Connector Type	Channel Range
3- & 5-pin XLR	Sockets	3, 4, 5, 6, 7, 9, 12, 15

### *Ordering*

COLORado™ Batten 144 Tour	20-pc 30° LED Lens Kit	24-pc 15° LED Lens Kit
01030105	01110081	01110082

---

**CHAUVET®**

5200 NW 108th Avenue  
Sunrise, FL 33351 (USA)  
(800) 762-1084 – (954) 929-1115  
FAX (954) 929-5560  
[www.chauvetlighting.com](http://www.chauvetlighting.com)

COLORado™ Batten 144 Tour User Manual Rev. 01e  
May 2011



*It's Green Thinking*